

Sonesse 30 RTS & Wirefree Roll Up RTS

Commissioning procedure

1 Motor overview

The motor head of the Sonesse and Wirefree Roll Up incorporates a program button and manual operation button.

The program button is used to configure the motor receiver into the programming mode (similar process compared with other Somfy RTS receivers – see page 19 for details).

The manual button allows you to operate the motor by pressing the button. When the button is pressed, the motor will operate in sequential control – Up, Stop, Down, Stop etc.

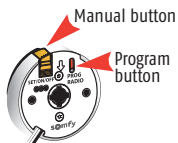

2 Power to the motor

Roll Up Wirefree RTS

Sonesse 30 RTS

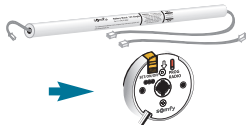

Connect battery pack – Continue to step 3



Connect DC supply/control – Continue to step 3

3 Control the motor and the correct direction of rotation

Press and hold simultaneously the Up and Down button. The blind should double shut.

Press and hold the Down button. Does the blind move down?

YES – The blind moves down while pressing the down button – Go to step 5

NO – The blind moves up while pressing the down button – Continue to step 4

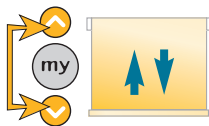

4 Reverse the direction of rotation

To reverse the direction of the motor, press and hold the Stop button until the blind double shunts.

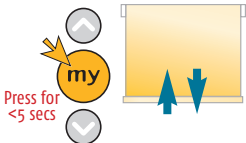

Press and hold the Down button to test that the motor direction is correct.

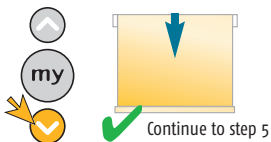

Soness 30 RTS & Wirefree Roll Up RTS

Commissioning procedure

5 Record the Up limit position

Use the Up button to move the blind until it reaches the Up limit position.



Press and hold the Stop and Down buttons until the blind starts to move down.



Stop the blind at the desired down limit position (adjust with Up or Down if required).



6 Record the down limit position

Press and hold the Stop and Up button until the blind starts to move up.

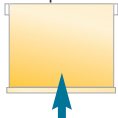

The blind will automatically stop at the up position.



Press and hold the Stop button until the blind double shunts to confirm the limit settings.



The limits have been recorded - Proceed to step 7 if you want to record a control

7 Programming the RTS control to the motor

Press the program button on the RTS control until the product double shunts.

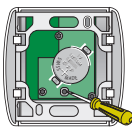

Centralis RTS

OR

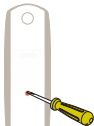

Telis RTS

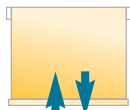

Double shunt = Control recorded ✓



Use only 1 RTS control throughout the commissioning procedure.

